



SENISTO SANITARYWARE LLP

S.no : 226/p1, Nr. Shiv Petrol Pump, Unchi Mandal,
Halvad Highway, Morbi - 363642, (Guj) INDIA.

E-mail: info@senistosanitaryware.com
Web: www.senistosanitaryware.com

Contact: +91 99097 32211

*Beyond Your
Imagination...*



The Sanitaryware showcase

The Sanitary ware showcase of the Senisto presents the finest sanitary ware reserved exclusively for the modern trend. These are closets, counter tops and basins that are adorned with class and sophistication and only those with taste would choose to spurge all over. The main ingredient of this collection is the richness of design that stands way above other contemporary offerings.



ABOUT US



Dear Colleagues, Partners and Well-Wishers,

SENISTO Sanitary Wares is a modernized enterprise integrated with R&D, manufacturing, sales and services, having a complete set of integrated sales team, applying brand strategy, setting up enterprise image, and being the advocator and Pioneer in the field of Ceramics.

We are feeling very happy to introduce our new venture SENISTO SANITARYWARE with wide range of Sanitaryware products and accessories.

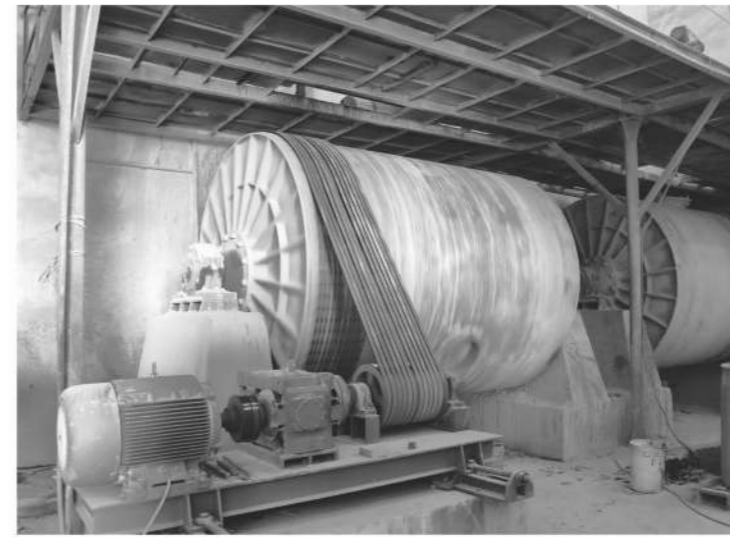
Keep improving and striving for excellence is the core strategy to our quality improvement. SENISTO SANITARYWARE is devoting itself to exploring deeper on global sanitary ware, so as to provide high-quality products and sincere, sophisticated services to the whole customers, to build up the better life for all human.

The people of SENISTO SANITARYWARE will put their best efforts in the direction of providing luxurious bathroom solutions to our respected customers. The dynamic team of marketing and the innovative technologists will design and style products for the demanding customers.

In our quest to make life great, we will always make our processes efficient to make pricing affordable to most of the people of our country and around the world. Our processes and management systems will be improved continuously to ensure that our bathroom solutions will value for money for the customer and a great business proposition for our dealers and distributors.

The future is challenging, but we are sure that we will beat the milestones set by us. We are setting a goal for future to meet our vision of being the most recognized brand in bathroom solution for a long time that make homes better and lives happier. We inspire people to live their Dreams and drives Growth.

Together we can beat the Best and Lets Make it Happen.



PRODUCTION

Always committed to interpreting new tastes and trends, SENISTO Sanitaryware looks to the future with continuous innovation of its process and products. This requires the integration of different skills, from the design to engineering, from chemistry to logistics, from marketing to sociology. The company has always paid great attention to saving energy and protecting the environment.

It is constantly evolving in order to continuously improve the functional performance and aesthetics of its collections. The wide range of shapes, sizes, colours and methods of installation of its products allows satisfying the different tastes and requirements of customers in a safe and precise manner.





CONTENTS

| | |
|----------------------|----|
| One Piece Closet | 12 |
| Wall Hung Closet | 28 |
| EWC Back to Wall | 34 |
| EWC Floor Mount | 36 |
| Table Tops | 40 |
| Wall Hung Basin | 60 |
| One Piece Basin | 68 |
| Wash Basin Pedestal | 76 |
| Half One Piece Basin | 88 |
| Counter Basin | 90 |
| Urinal | 92 |
| Orissa Pan | 94 |
| Accessories | 95 |
| Designer | 96 |



MARCO-S

One Piece Closet
26" x 14" x 30"
Center of outlet to wall 9"

SESA

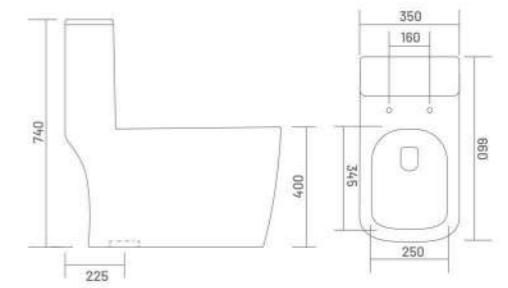
One Piece Basin
15" x 15" x 34"

CLOSETS



senisto
MARCO-S (Syphonic)
 One Piece Closet
 26" x 14" x 30"
 Center of outlet to wall 9"

-  SYPHONIC FLUSH
-  RIMLESS DESIGN
-  TORNADO FLUSH
-  SOFT CLOSE SEAT COVER
-  DUAL FLUSH
-  WATER SAVING
-  ANTI BACTERIAL



RIMLESS DESIGN ▶

 MORE HYGIENIC

 MORE ECOLOGICAL

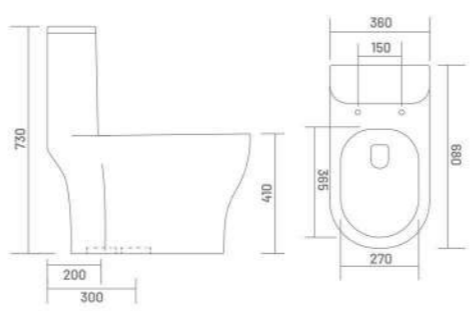




AUDI-S (Syphonic)

One Piece Closet
28" x 16" x 30"
Center of outlet to wall 8"/12"

- SYPHONIC FLUSH
- RIMLESS DESIGN
- TORNADO FLUSH
- SOFT CLOSE SEAT COVER
- DUAL FLUSH
- WATER SAVING
- ANTI BACTERIAL



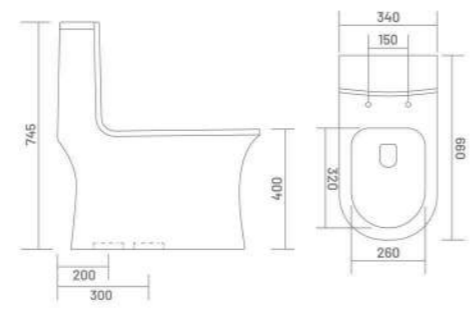
4D - FLUSHING TECHNOLOGY



LUNAR-S (Syphonic)

One Piece Closet
26" x 15" x 30"
Center of outlet to wall 8"/12"

- SYPHONIC FLUSH
- RIMLESS DESIGN
- TORNADO FLUSH
- SOFT CLOSE SEAT COVER
- DUAL FLUSH
- WATER SAVING
- ANTI BACTERIAL

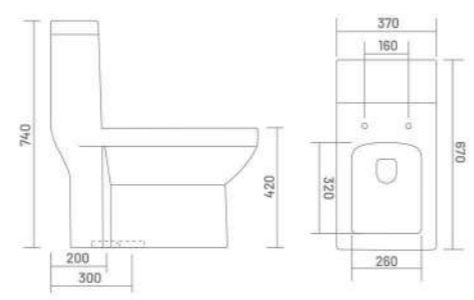




RADO-S (Syphonic)

One Piece Closet
26" x 15" x 30"
Center of outlet to wall 8"/12"

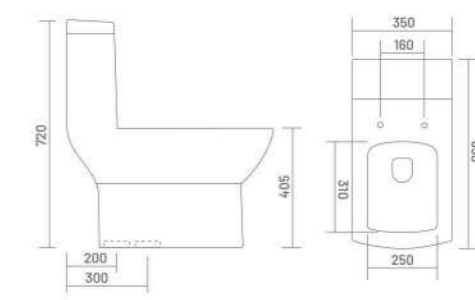
- SYPHONIC FLUSH
- SOFT CLOSE SEAT COVER
- DUAL FLUSH
- WATER SAVING
- ANTI BACTERIAL



AMEO-S (Syphonic)

One Piece Closet
26" x 14" x 31"
Center of outlet to wall 8"/12"

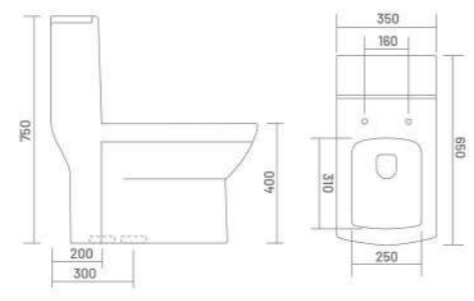
- SYPHONIC FLUSH
- SOFT CLOSE SEAT COVER
- DUAL FLUSH
- WATER SAVING
- ANTI BACTERIAL



PAJERO-S (Syphonic)

One Piece Closet
26" x 14" x 30"
Center of outlet to wall 8"/12"

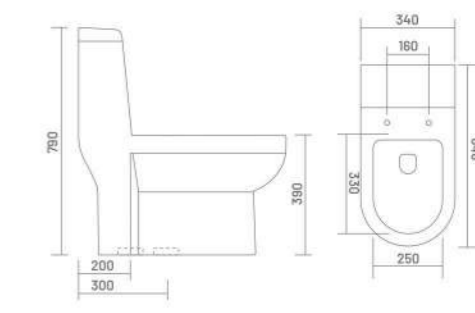
- SYPHONIC FLUSH
- SOFT CLOSE SEAT COVER
- DUAL FLUSH
- WATER SAVING
- ANTI BACTERIAL



BRAVO-S (Syphonic)

One Piece Closet
25" x 14" x 30"
Center of outlet to wall 8"/12"

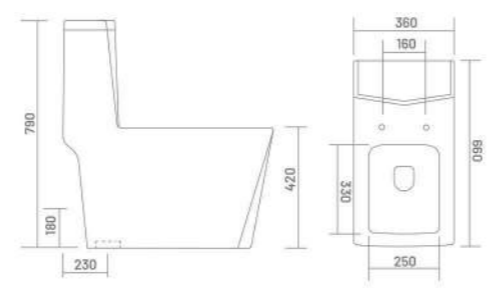
- SYPHONIC FLUSH
- RIMLESS DESIGN
- SOFT CLOSE SEAT COVER
- DUAL FLUSH
- WATER SAVING
- ANTI BACTERIAL





DIAMOND-S/P
 One Piece Closet
 26" x 14" x 31"
 Center of outlet to wall 9"

- 
WASH DOWN
FLUSH
- 
SOFT CLOSE
SEAT COVER
- 
DUAL
FLUSH
- 
WATER
SAVING
- 
ANTI
BACTERIAL

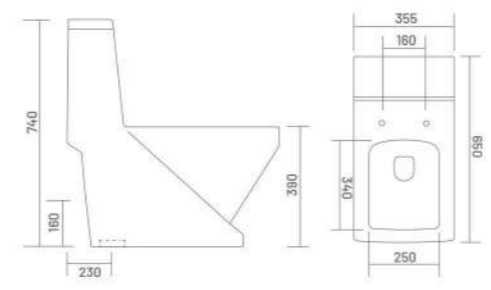


SHAPE
 FOR NEXT
 GENERATION



SOSEN-S/P
 One Piece Closet
 26" x 14" x 29"
 Center of outlet to wall 9"

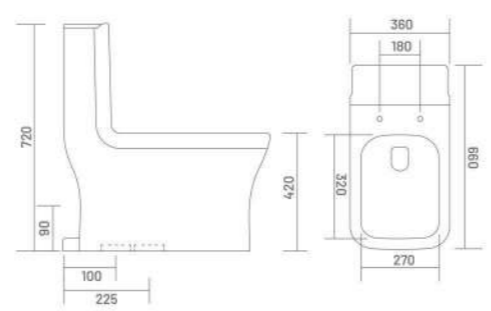
- 
WASH DOWN
FLUSH
- 
SOFT CLOSE
SEAT COVER
- 
DUAL
FLUSH
- 
WATER
SAVING
- 
ANTI
BACTERIAL





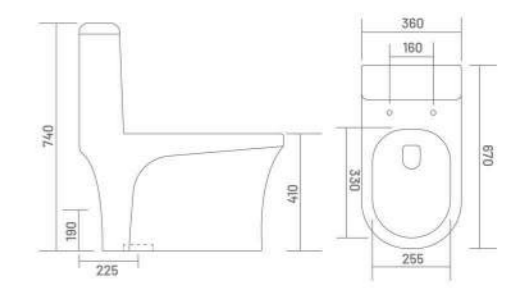
SCOP-S/P
 One Piece Closet
 26" x 14" x 29"
 Center of outlet to wall 4"/9"

- WASH DOWN FLUSH
- SOFT CLOSE SEAT COVER
- DUAL FLUSH
- WATER SAVING
- ANTI BACTERIAL



COCO-S/P
 One Piece Closet
 26" x 14" x 29"
 Center of outlet to wall 9"

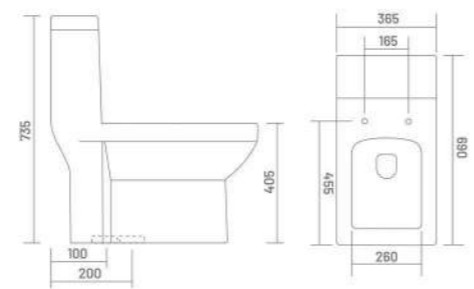
- WASH DOWN FLUSH
- SOFT CLOSE SEAT COVER
- DUAL FLUSH
- WATER SAVING
- ANTI BACTERIAL



NEW ARRIVAL

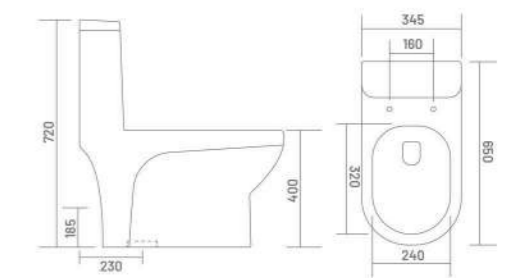
TESLA
 One Piece Closet
 28" x 15" x 29"
 Center of outlet to wall 4"/9"

- WASH DOWN FLUSH
- SOFT CLOSE SEAT COVER
- DUAL FLUSH
- WATER SAVING
- ANTI BACTERIAL



VIVA-S/P
 One Piece Closet
 26" x 14" x 29"
 Center of outlet to wall 9"

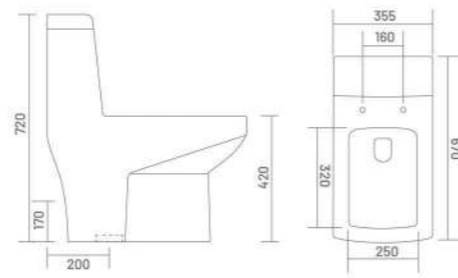
- WASH DOWN FLUSH
- SOFT CLOSE SEAT COVER
- DUAL FLUSH
- WATER SAVING
- ANTI BACTERIAL





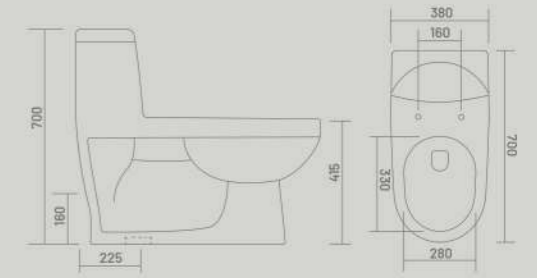
VEGA-S/P

One Piece Closet
26" x 14" x 29"
Center of outlet to wall 9"/12"



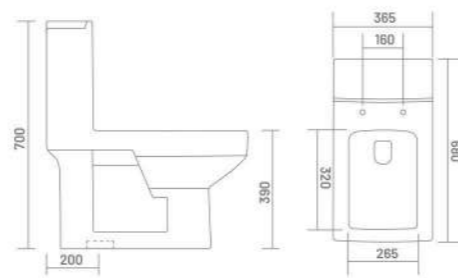
VENTO-S/P

One Piece Closet
28" x 15" x 28"
Center of outlet to wall 9"



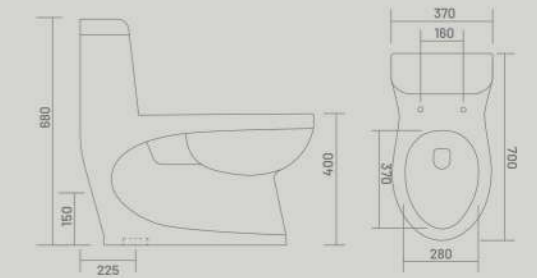
COSMO-S

One Piece Closet
27" x 14" x 29"
Center of outlet to wall 9"



POLO-S/P

One Piece Closet
28" x 15" x 27"
Center of outlet to wall 9"



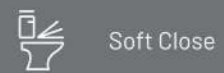
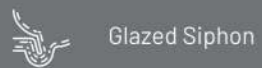
RIMLESS-DESIGN

TOILET BOWL WITHOUT AN EDGE

The rimless design is standard for all special toilets. It means that the toilet bowls do not have any difficult-to-reach places in which dirt and bacteria can accumulate. This makes it possible to clean the toilet far more quickly, easily and thoroughly. SENISTO has produced rimless toilet bowls.



EASY TO CLEAN





IBIS

Wall Hung Closet
23" x 14" x 15"



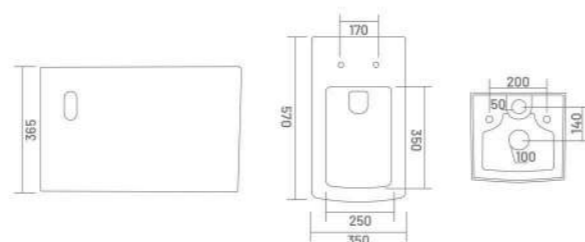
INFINITY

Table Top Basin
16" x 16" x 5"



IBIS
Wall Hung Closet
23" x 14" x 15"

SOFT CLOSE SEAT COVER ANTI BACTERIAL

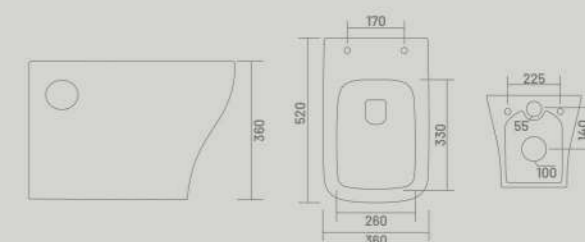


INBUILT JET



SMITH
Wall Hung Closet
21" x 14" x 14"

SOFT CLOSE SEAT COVER ANTI BACTERIAL

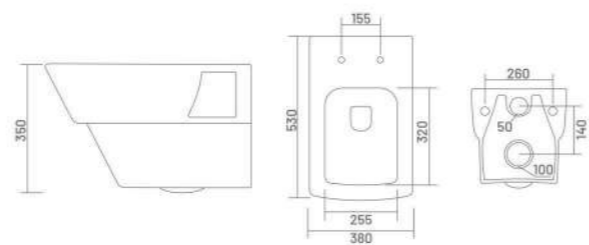


INBUILT JET



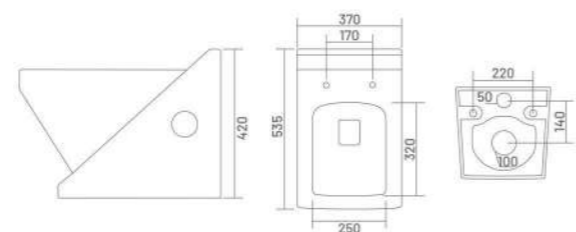
ACCORD
Wall Hung Closet
21" x 15" x 14"

- SOFT CLOSE SEAT COVER
- ANTI BACTERIAL



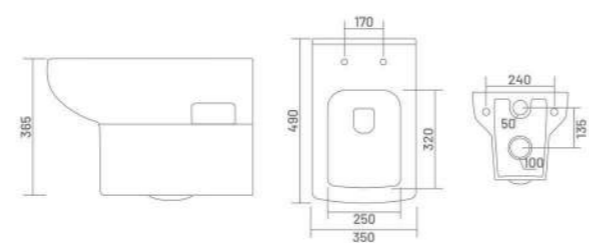
SANITO
Wall Hung Closet
21" x 15" x 17"

- SOFT CLOSE SEAT COVER
- ANTI BACTERIAL



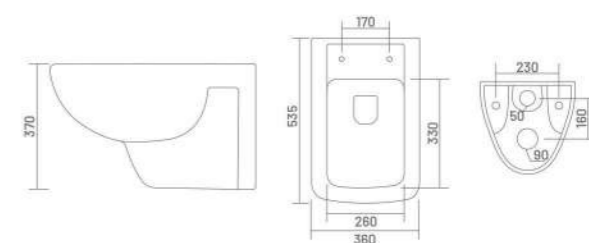
SOYOTO
Wall Hung Closet
19" x 14" x 15"

- SOFT CLOSE SEAT COVER
- ANTI BACTERIAL



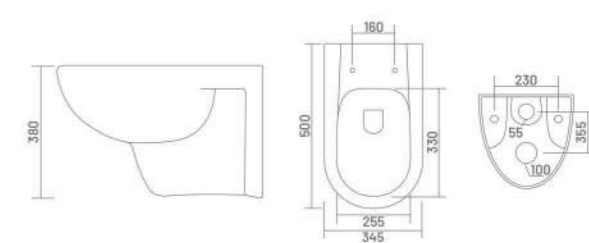
ALTO
Wall Hung Closet
21" x 14" x 15"

- RIMLESS DESIGN
- SOFT CLOSE SEAT COVER
- ANTI BACTERIAL



ENIGMA
Wall Hung Closet
19" x 14" x 15"

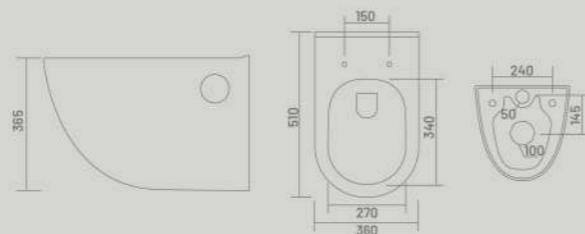
- RIMLESS DESIGN
- SOFT CLOSE SEAT COVER
- ANTI BACTERIAL





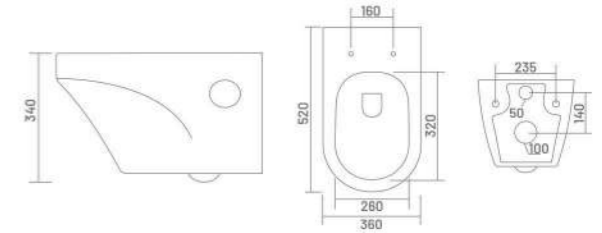
ROB
Wall Hung Closet
20" x 14" x 15"

-  RIMLESS DESIGN
-  SOFT CLOSE SEAT COVER
-  ANTI BACTERIAL



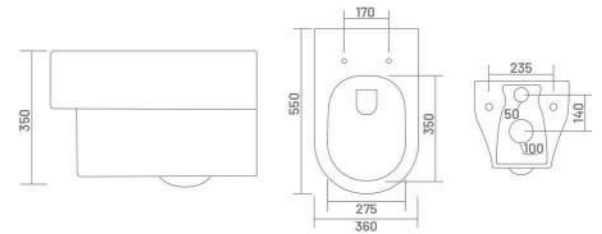
CLASSIC
Wall Hung Closet
21" x 14" x 14"

-  RIMLESS DESIGN
-  SOFT CLOSE SEAT COVER
-  ANTI BACTERIAL



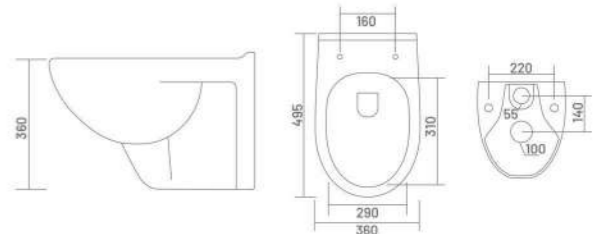
OTTO
Wall Hung Closet
22" x 14" x 14"

-  SOFT CLOSE SEAT COVER
-  ANTI BACTERIAL



BABY
Wall Hung Closet
19" x 14" x 14"

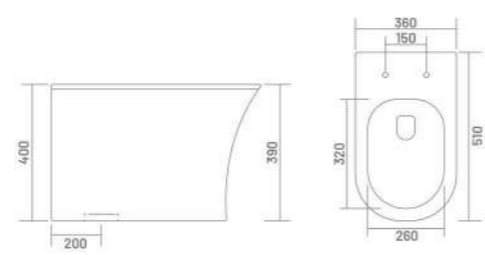
-  RIMLESS DESIGN
-  SOFT CLOSE SEAT COVER
-  ANTI BACTERIAL





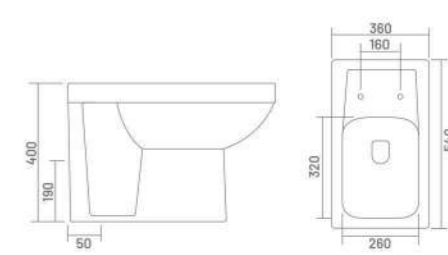
LUMINA-S (Syphonic)
EWC Back to Wall
20" x 14" x 16"

- SYPHONIC FLUSH
- RIMLESS DESIGN
- TORNADO FLUSH
- SOFT CLOSE SEAT COVER
- WATER SAVING
- ANTI BACTERIAL

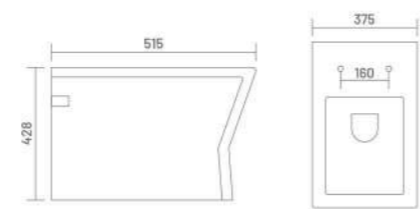


KENZO-S/P
EWC Back to Wall
22" x 14" x 16"

- SOFT CLOSE SEAT COVER
- ANTI BACTERIAL

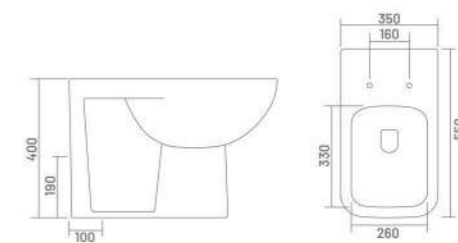


LIVA
EWC Back to Wall
21" x 15" x 17"



KOBRA-S/P
EWC Back to Wall
22" x 14" x 16"

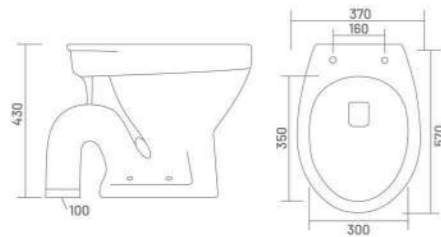
- SOFT CLOSE SEAT COVER
- ANTI BACTERIAL





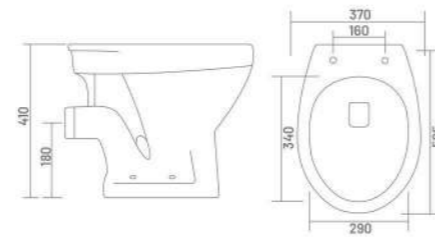
PERRYWARE E.W.C.-S

EWC Floor Mount
23" x 15" x 17"



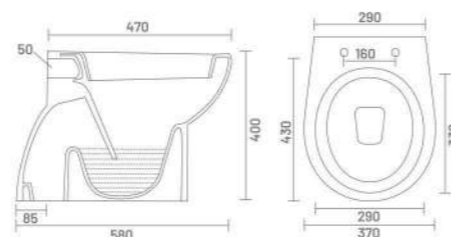
PERRYWARE E.W.C.-P

EWC Floor Mount
21" x 15" x 17"



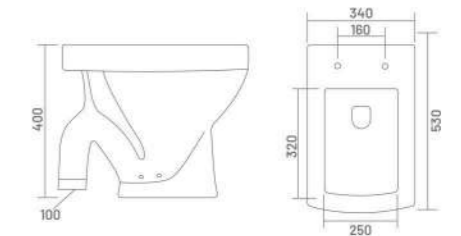
SELVO CONCEALED E.W.C.-S

EWC Floor Mount
23" x 15" x 16"



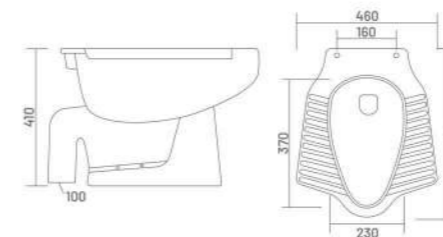
TORO-S

EWC Floor Mount
21" x 14" x 16"



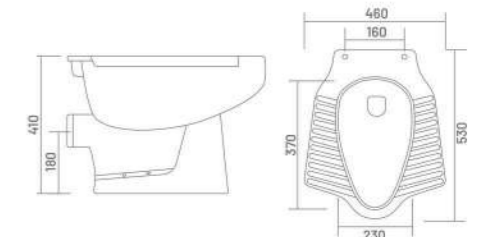
ANGLO INDIAN E.W.C.-S

EWC Floor Mount
23" x 18" x 16"



ANGLO INDIAN E.W.C.-P

EWC Floor Mount
21" x 18" x 16"





KENZO-S/P
EWC Back to Wall
22" x 14" x 16"



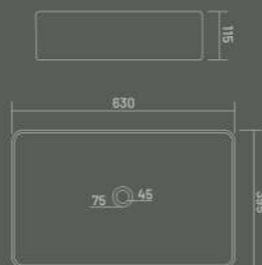
ROCKET
Table Top Basin
25" x 16" x 5"

TABLE TOP

TABLE TOP



ROCKET
Table Top Basin
25" x 16" x 5"



THIN RIM

Elegant THIN EDGE basin with fine edges that is only 5 mm in thickness. The Attractive clay art is made by the innovative material used by SENISTO.

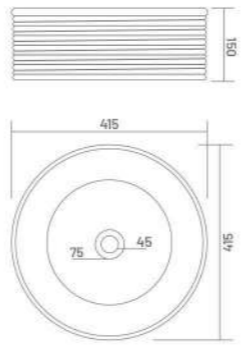




NEW ARRIVAL

OCEAN
 Table Top Basin
 16" x 16" x 6"

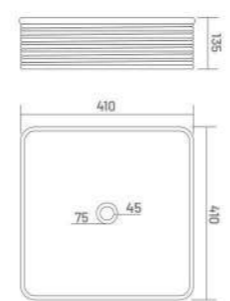
 THIN RIM DESIGN



NEW ARRIVAL

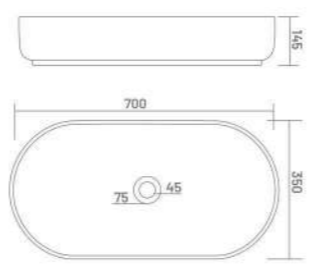
INFINITY
 Table Top Basin
 16" x 16" x 5"

 THIN RIM DESIGN



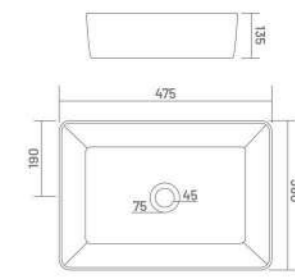


TOPIC
Table Top Basin
28" x 14" x 5"



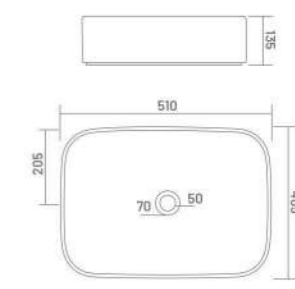
CROMA
Table Top Basin
19" x 15" x 5"

THIN RIM DESIGN

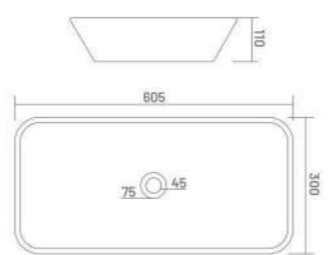


RADON
Table Top Basin
20" x 16" x 5"

THIN RIM DESIGN

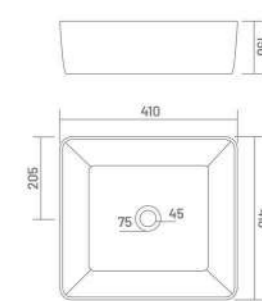


ABRA
Table Top Basin
24" x 12" x 4"



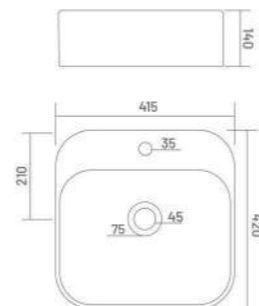
SOLEX
Table Top Basin
16" x 16" x 6"

THIN RIM DESIGN

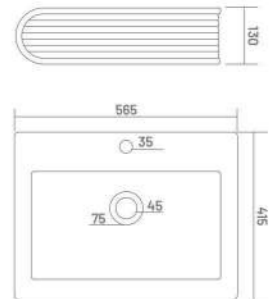




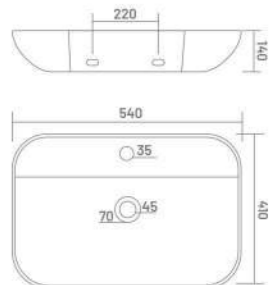
EURO
Table Top / Wall Hung Basin
16" x 16" x 5"



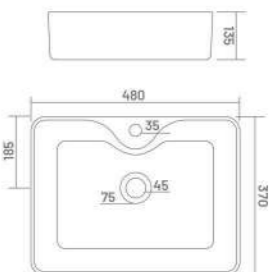
SMART
Table Top / Wall Hung Basin
23" x 17" x 5"



BREZZA
Table Top / Wall Hung Basin
22" x 16" x 5"

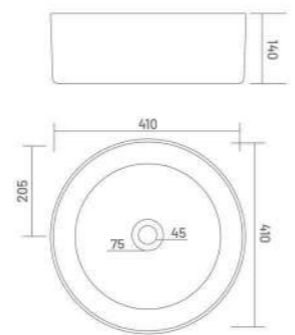


SWIFT
Table Top Basin
20" x 15" x 5"

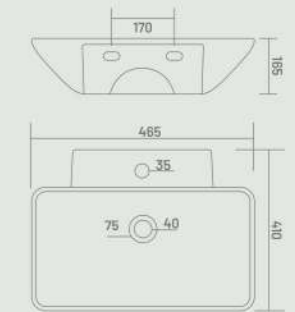




ZERO
Table Top Basin
16" x 16" x 6"

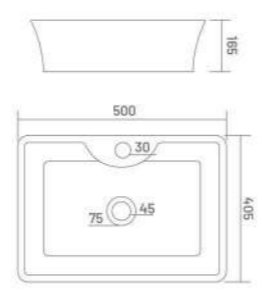


MONO
Table Top Basin
18" x 16" x 6"

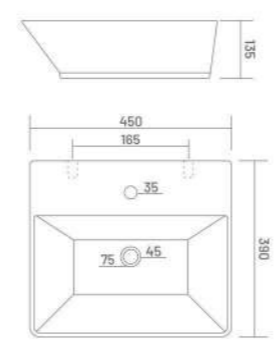




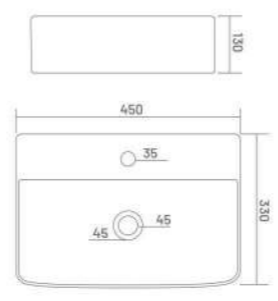
SPIRIT GOLD
Table Top Basin
20" x 16" x 7"



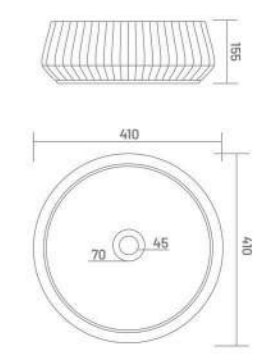
LENOVA
Table Top / Wall Hung Basin
18" x 15" x 5"



ZEN
Table Top Basin
18" x 13" x 5"

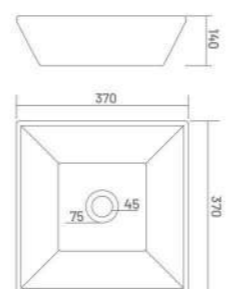


CERA
Table Top Basin
16" x 16" x 6"

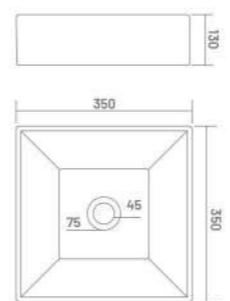




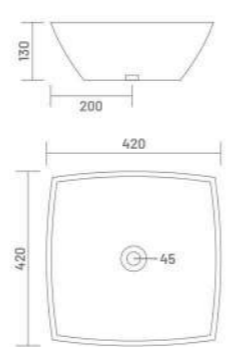
ALVIN
Table Top Basin
15" x 15" x 5"



RIYO
Table Top Basin
14" x 14" x 5"



SONY
Table Top Basin
17" x 17" x 6"





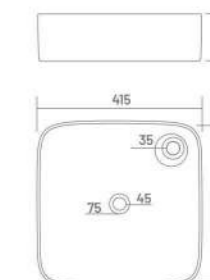
NEW ARRIVAL

GENX
Table Top Basin
18" x 13" x 5"

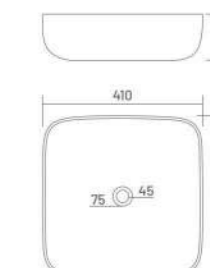


NEW ARRIVAL

ANTILA
Table Top Basin
16" x 16" x 6"

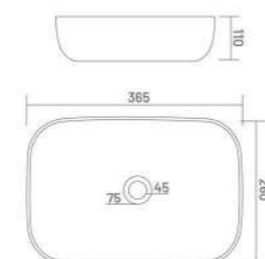


CAMPUS
Table Top Basin
16" x 16" x 6"

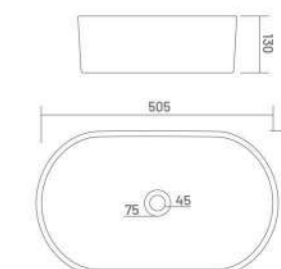


NEW ARRIVAL

ALEX
Table Top Basin
14" x 10" x 4"

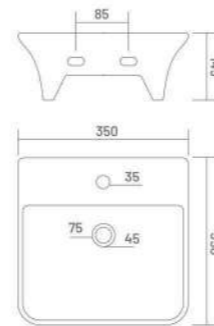


CAPSULE
Table Top Basin
20" x 13" x 5"





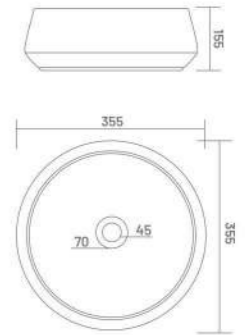
LEXO
Table Top Basin
14" x 14" x 6"



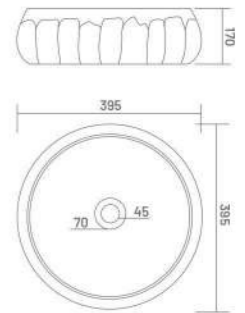
SEMI
Table Top Basin
14" x 14" x 6"



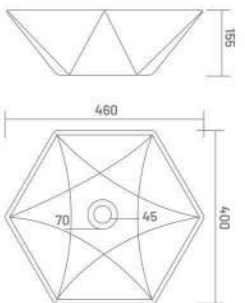
VITARA
Table Top Basin
14" x 14" x 6"



TITLE
Table Top Basin
15" x 15" x 7"



STAR
Table Top Basin
18" x 16" x 6"



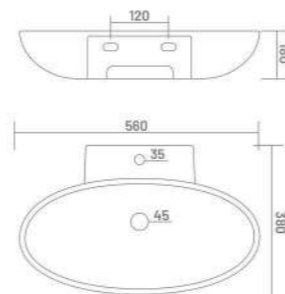


AFFIL

Table Top / Wall Hung Basin
22" x 15" x 7"



TABLE TOP / WALL HUNG BASIN

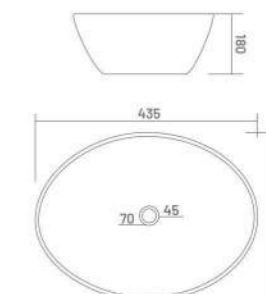


SPENZO

Table Top Basin
17" x 14" x 7"



THIN RIM DESIGN

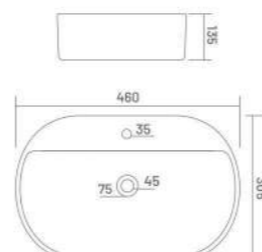


CRUZE

Table Top Basin
18" x 12" x 6"



TABLE TOP / WALL HUNG BASIN

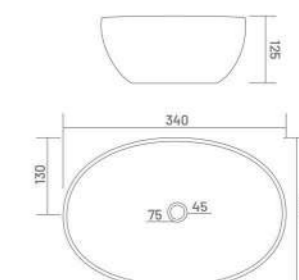


LAKE

Table Top Basin
14" x 10" x 5"



THIN RIM DESIGN

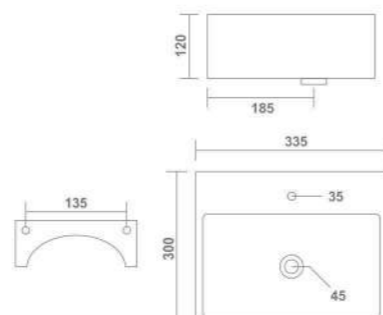


LEO

Table Top / Wall Hung Basin
13" x 12" x 5"



TABLE TOP / WALL HUNG BASIN

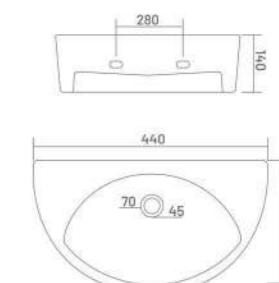


NIKI

Table Top / Wall Hung Basin
18" x 12" x 6"

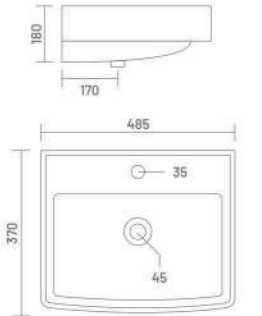


TABLE TOP / WALL HUNG BASIN

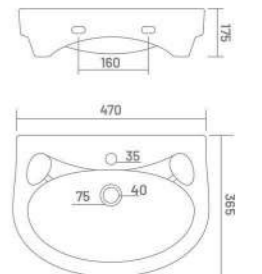




RIWA
Wall Hung Basin
19" x 15" x 7"

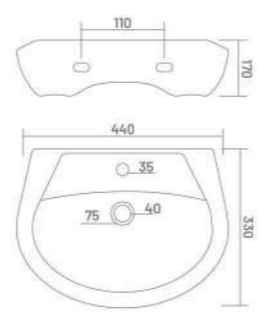


ROYAL
Wall Hung Basin
18" x 14" x 7"

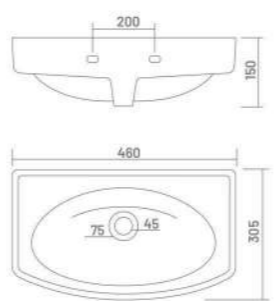




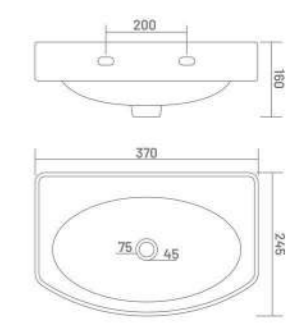
SHARP
Wall Hung Basin
18" x 13" x 7"



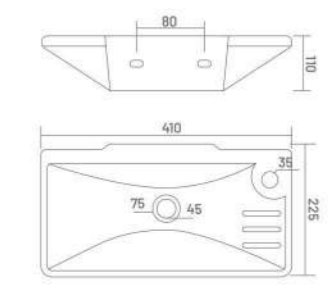
STEFIN
Wall Hung Basin
18" x 12" x 6"



SHALLY
Wall Hung Basin
15" x 10" x 6"

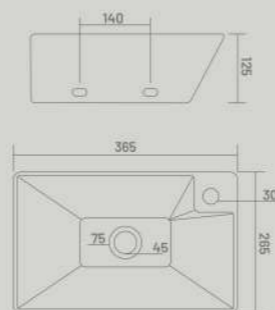


SHIPLA
Wall Hung Basin
16" x 9" x 4"





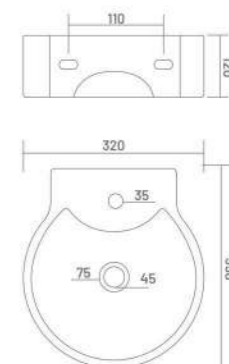
SOGO
Wall Hung Basin
15" x 11" x 5"



FLORA
Wall Hung Basin
10" x 13" x 5"

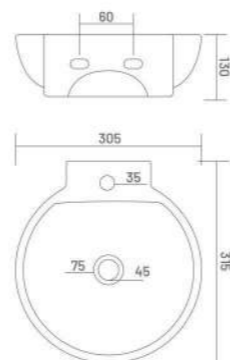


AMPLE
Wall Hung Basin
13" x 14" x 5"

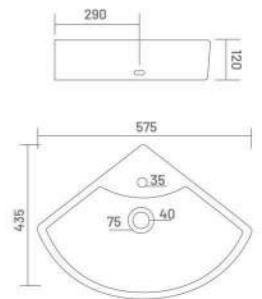




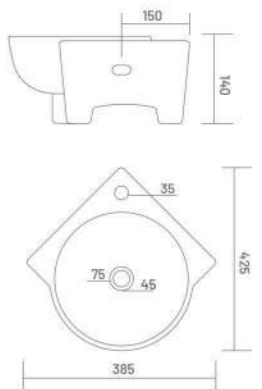
TECCO
Wall Hung Basin
12" x 12" x 5"



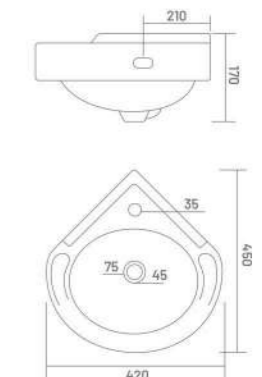
SONA
Wall Hung Basin
23" x 17" x 5"



MOTTO
Wall Hung Basin
15" x 17" x 6"

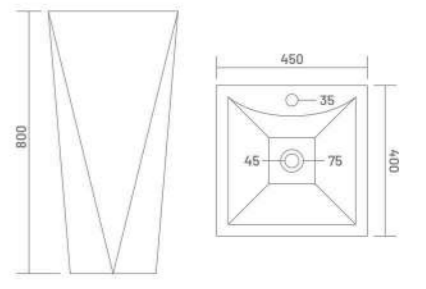


SATIN CORNER
Wall Hung Basin
17" x 18" x 7"

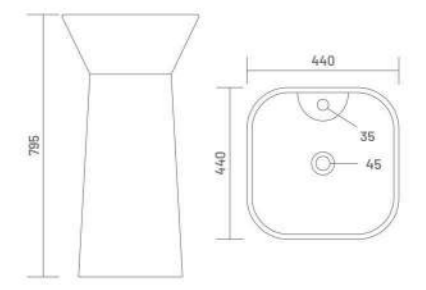




DIAMOND
One Piece Basin
18" x 16" x 32"

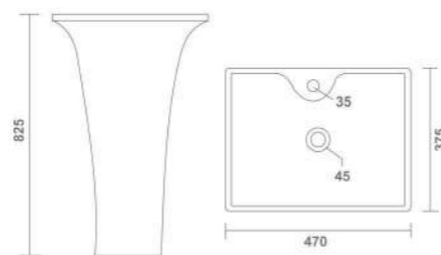


CRETA
One Piece Basin
18" x 18" x 32"

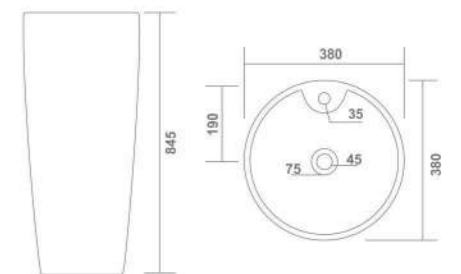




RICH
One Piece Basin
19" x 15" x 33"

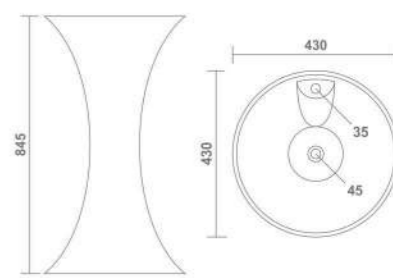


SCORPIO
One Piece Basin
15" x 15" x 34"

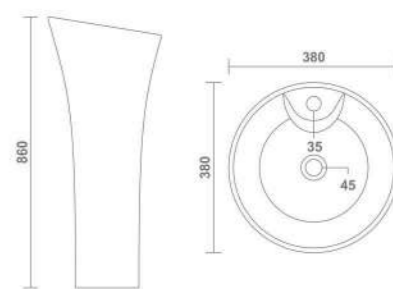




TOTO
One Piece Basin
17" x 17" x 34"



SESA
One Piece Basin
15" x 15" x 34"





RADO-S

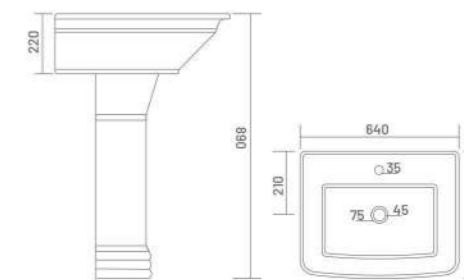
One Piece Closet
26" x 15" x 30"
Center of outlet to wall 9"/12"

WINGO

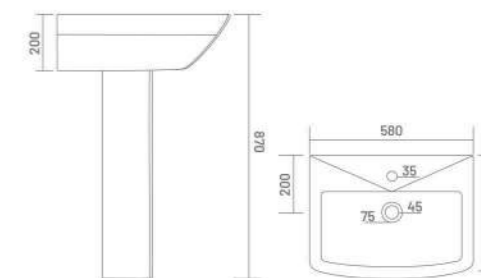
Wash Basin Pedestal
22" x 16" x 33"



SENISTO GOLD
Wash Basin Pedestal
25" x 20" x 36"



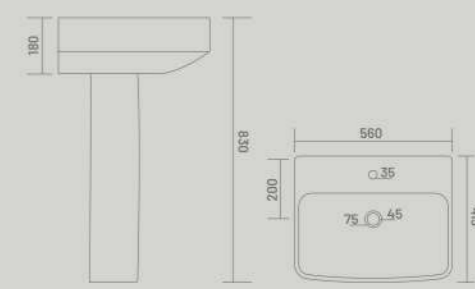
DIAMOND
Wash Basin Pedestal
23" x 21" x 35"



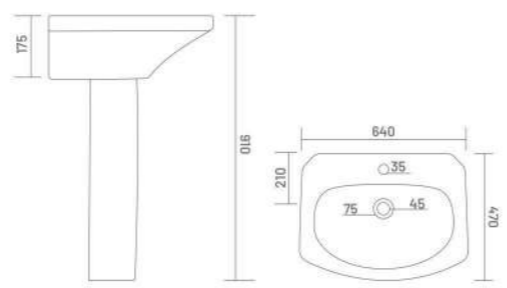
NEW ARRIVAL



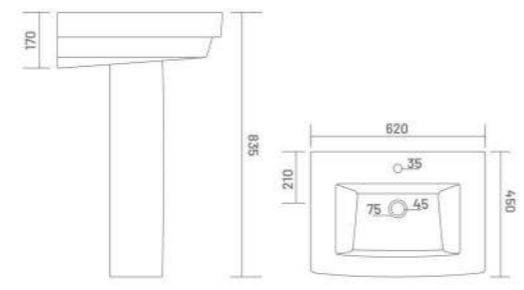
WINGO
Wash Basin Pedestal
22" x 16" x 33"



RAPID
Wash Basin Pedestal
25" x 19" x 36"

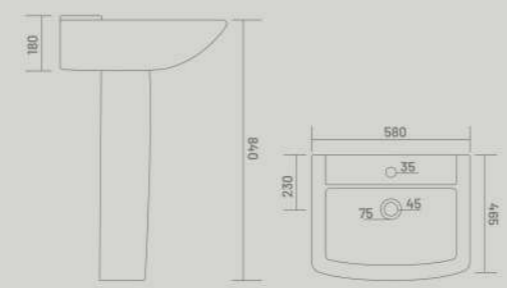


KOYO
Wash Basin Pedestal
25" x 18" x 33"

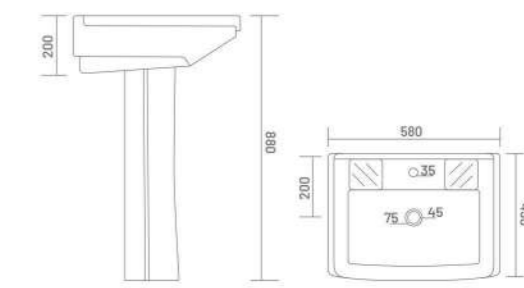




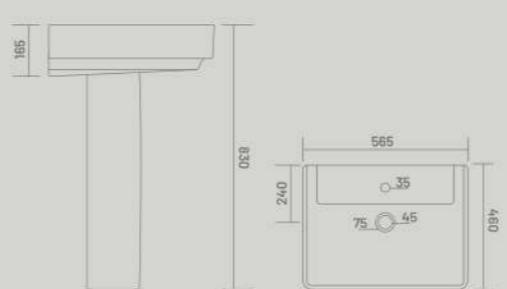
MAPS
Wash Basin Pedestal
23" x 18" x 34"



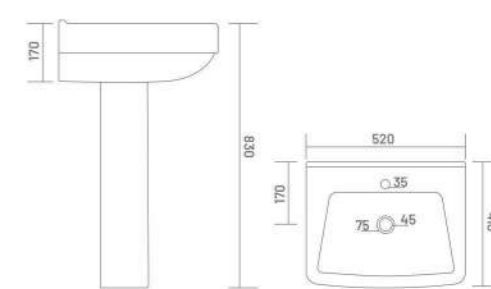
SOPHIA
Wash Basin Pedestal
23" x 17" x 35"



SONATA
Wash Basin Pedestal
22" x 18" x 33"

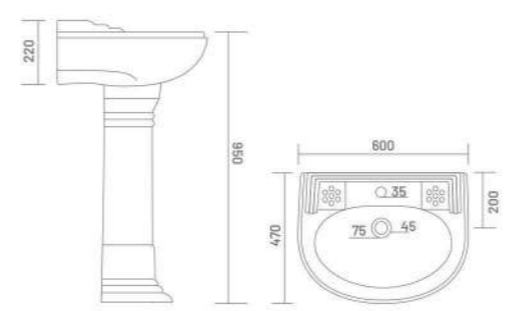


VOX
Wash Basin Pedestal
20" x 16" x 33"

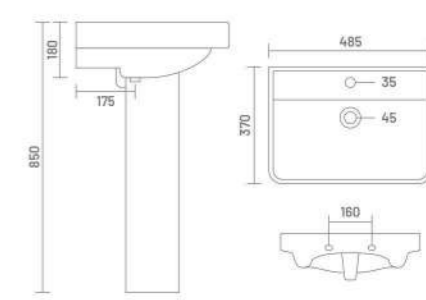




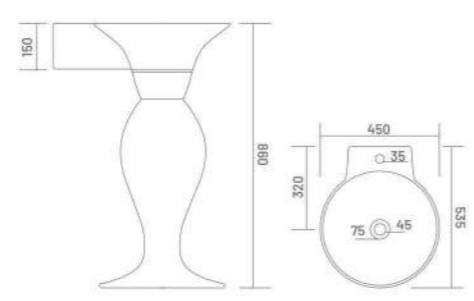
SERENA
Wash Basin Pedestal
24" x 19" x 39"



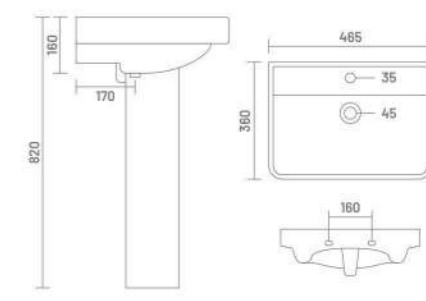
RIWA
Wash Basin Pedestal
20" x 15" x 34"



DOLPHIN
Wash Basin Pedestal
18" x 21" x 34"

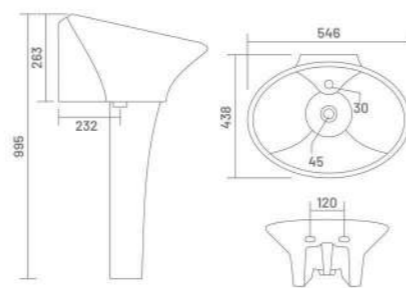


JOYO
Wash Basin Pedestal
18" x 14" x 33"

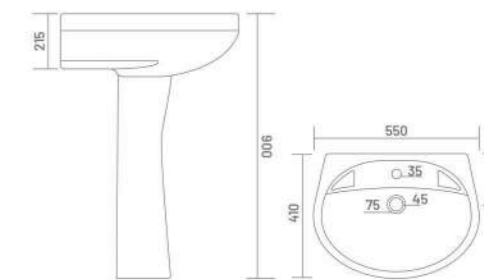




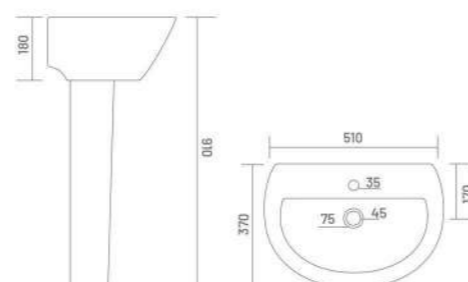
SPENTA
Wash Basin Pedestal
22" x 18" x 40"



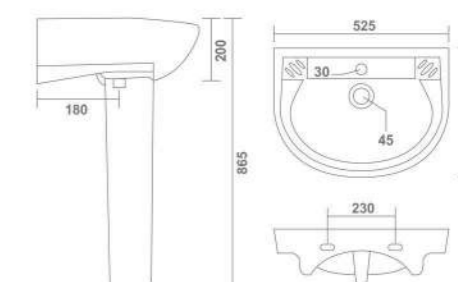
MINAL
Wash Basin Pedestal
22" x 16" x 36"



SCOOTY
Wash Basin Pedestal
20" x 15" x 36"



SAMITE
Wash Basin Pedestal
21" x 17" x 35"





LUNAR-S

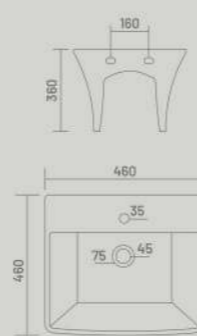
One Piece Closet
26" x 15" x 30"
Center of outlet to wall 9"/12"

DOVE

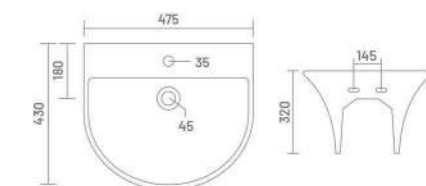
Half One Piece Basin
19" x 17" x 13"



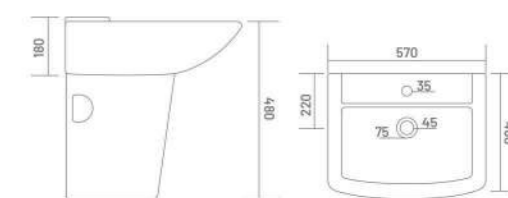
SALSA
Half One Piece Basin
18" x 18" x 14"



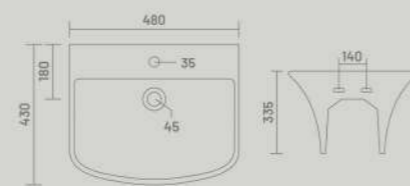
DOVE
Half One Piece Basin
19" x 17" x 13"



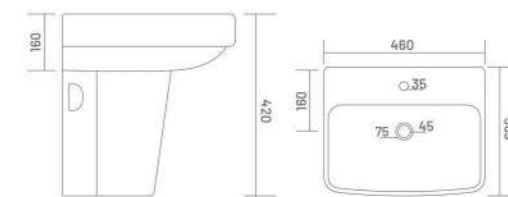
MAPS
Half One Piece Basin
23" x 19" x 19"



DOVEL
Half One Piece Basin
19" x 17" x 13"



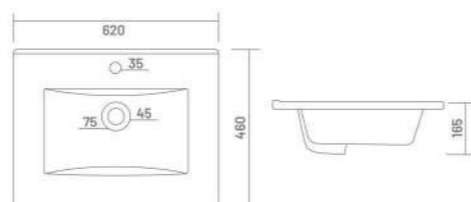
JOYO
Half One Piece Basin
18" x 14" x 19"





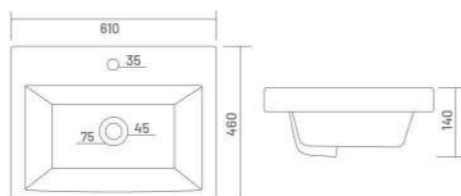
REX

Counter Top Basin
25" x 19" x 7"



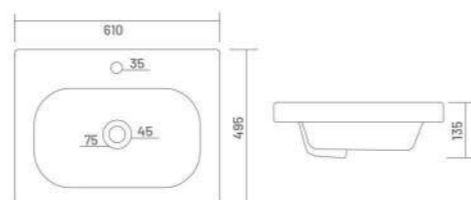
SENDY

Counter Top Basin
24" x 18" x 6"



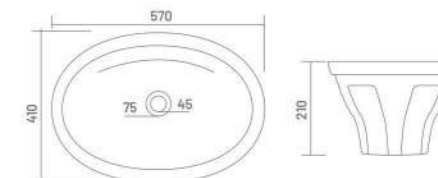
BELLY

Counter Top Basin
24" x 18" x 5"



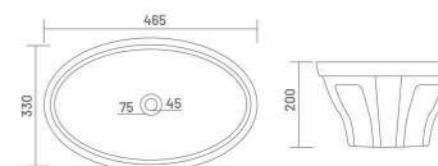
REMBO

Counter Top Basin
23" x 16" x 8"



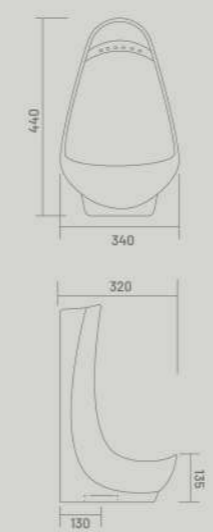
SIMPLE

Under Counter Basin
19" x 13" x 8"

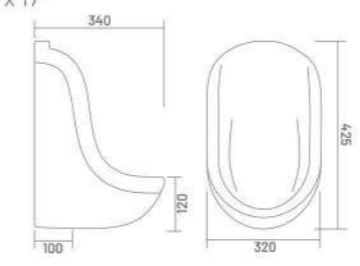




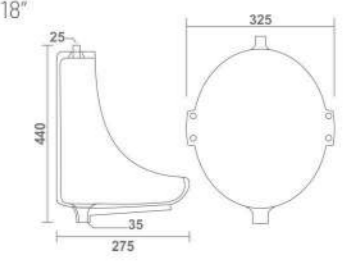
WIND
Urinal
14" x 13" x 18"



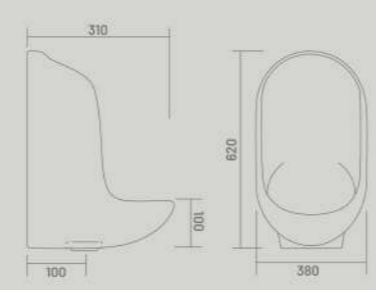
NANO LARGE
Urinal
13" x 13" x 17"



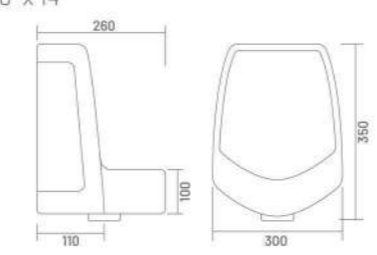
FLAT BACK
Urinal
13" x 11" x 18"



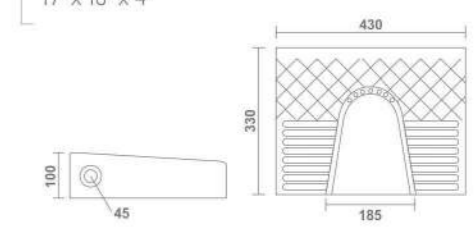
LARGE URINAL
Urinal
15" x 12" x 25"



CORNER URINAL
Urinal
12" x 10" x 14"

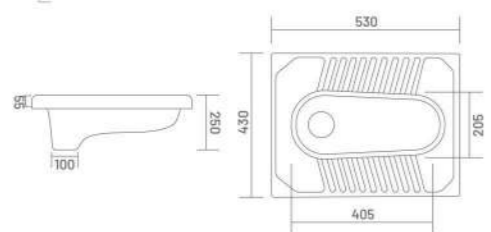


SQUATTING
Urinal
17" x 13" x 4"

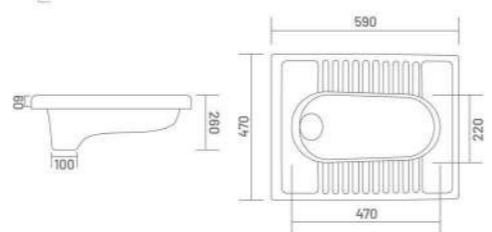




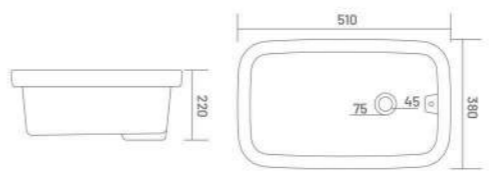
ORISSA PAN - 20"
Pan
20" x 17" x 10"



ORISSA PAN - 23"
Pan
23" x 19" x 10"



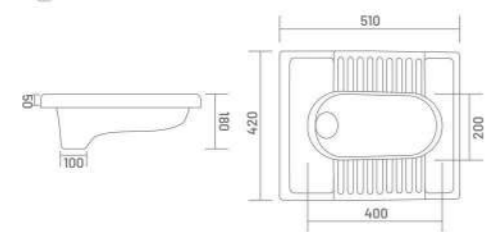
LAB SINK
20" x 15" x 8"



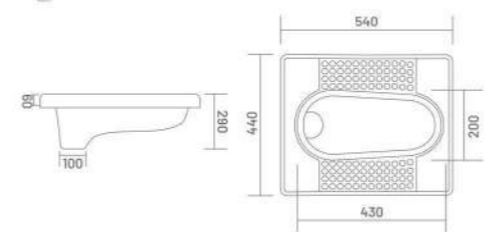
CISTERN - 001



CT PAN - 20"
Pan
20" x 17" x 7"



AQUA PAN - 21"
Pan
21" x 18" x 12"



ONE PIECE FITTING



S-TRAP



P-TRAP



DESIGNER COLLECTION

*Beyond Your
Imagination...*



SCORPIO - 905



SCORPIO - 902



SCORPIO - 906



SCORPIO - 907



SCORPIO - 911



SCORPIO - 914



SCORPIO - 915



SCORPIO - 916



SCORPIO - 917



RICH - 701



RICH - 705



SCORPIO - 918



SCORPIO - 919



RICH - 711



RICH - 712



RICH - 713



RICH - 714



SESA - 504



SESA - 505



RICH - 715



RICH - 716



SESA - 509



SESA - 510



SESA - 515



SESA - 516



SESA - 518



SESA - 520



SESA - 519



SESA - 521



SESA - 522



TOTO - 602



TOTO - 609



TOTO - 610



TOTO - 611



TOTO - 612



ROCKET - 5004



RADON - 2007



ROCKET - 5002



ROCKET - 5003



RADON - 2001



RADON - 2003



ROCKET - 5005



RADON - 2005



RADON - 2006



EURO - 6004



EURO - 6003



EURO - 6005



EURO - 6006



EURO - 6007



SWIFT - 11001



SWIFT - 11006



SWIFT - 11009



ZEN - 3003



ZEN - 3004



CAMPUS - 013



ZEN - 3005



ZEN - 3006



CAMPUS - 009



CAMPUS - 011



CAMPUS - 001



CAMPUS - 002



CAMPUS - 012



CAMPUS - 014



CAPSULE - 7005



CAPSULE - 7007



CAPSULE - 7008



CAPSULE - 7009



CAPSULE - 7010



CAPSULE - 7011



GENX - 4004



GENX - 4001



GENX - 4002



GENX - 4011



GENX - 4003



GENX - 4005



GENX - 4008



GENX - 4009



GENX - 4006



GENX - 4007



GENX - 4010



GENX - 4012



GENX - 4013



GENX - 4014



GENX - 4015



GENX - 4017



VITARA - 9001



TITLE - 1111



VITARA - 9003



VITARA - 9004



VITARA - 9005



VITARA - 9006



SPENZO - 1001



SPENZO - 1007



VITARA - 9014



VITARA - 9015



SPENZO - 1010



SPENZO - 1014



VITARA - 9016



VITARA - 9017



SPENZO - 1015



SPENZO - 1016

Designer | Table Top Basin



SPENZO - 1023



SPENZO - 1018



SPENZO - 1024



SPENZO - 1025



SPENZO - 1026

Designer | Wash Basin Pedestal



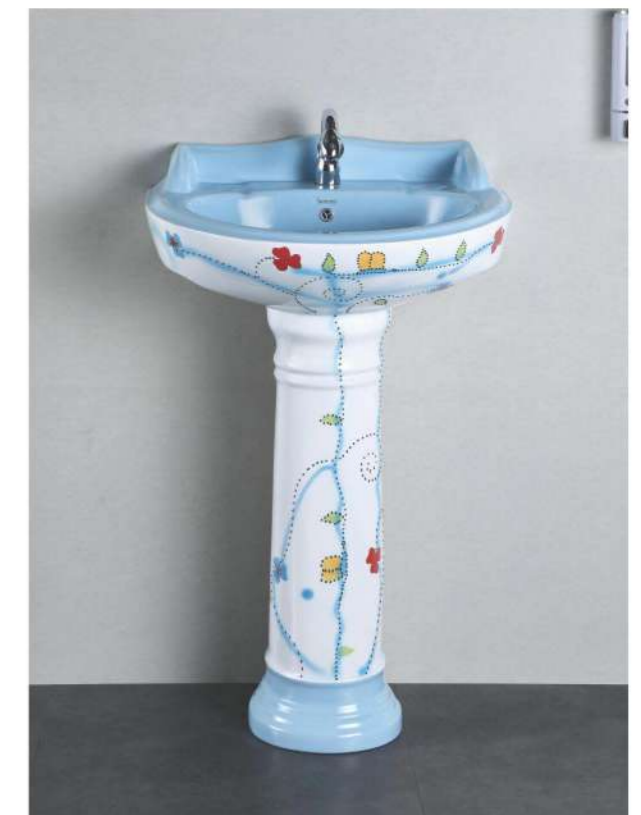
SERENA - 303



SERENA - 307



SERENA - 308



SERENA - 309



SERENA - 311



SERENA - 314



SERENA - 322



SERENA - 327



SERENA - 315



SERENA - 321



SERENA - 328



SERENA - 329



DOLPHIN - 401



DOLPHIN - 403



DOLPHIN - 407



DOLPHIN - 413



DOLPHIN - 404



DOLPHIN - 405



DOLPHIN - 414



DOLPHIN - 417



SCOP - S1



SCOP - S2



SCOP - S3



SCOP - S4



SCOP - S5

COLOURS

Running



Special



Super Special



Colours printed above may differ from original colours of ceramics. For actual selection refer samples or shade board.

Wall & Floor Mounted PVC Cabinet Vanity Manufacturer

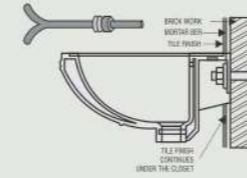
Our Group
of Company



Plot No. 2, B/h. Marvel Packaging, At. Rangpar,
Jetpar Road, Morbi - 2.
E-mail : afonbathware@gmail.com
Contact : +91 90993 99924 | 99099 72201

TROUBLESHOOTING GUIDE

| ITEM | PROBLEM | PROBABLE REASONS | CORRECTIVE ACTIONS |
|-----------------------------|--|--|--|
| Wash Basins / Table Top | 1. Overflow Chocked And Foul Bed Odor | Waste Coupling Used May Be Full Threaded | Waste Coupling Should Be Changed To Slot Cut Coupling |
| | 2. Water Deposit On Tap Platform Area And Inside Bowl Area | Basin Is Not Fixed In Level Or Bracket Is Not In Level | Should Be Done By Proper Leveling |
| | 3. There Is No Tap Hole In Basin | Tap Hole Could Be Semi Punched From Back Side | Tap Hole Should Be Created By Plumber From Semipunched Area |
| Ewc / Pan / Anglo Indian | 1. Water Not Coming In Bowl Area While Flushing | Flush Bend Is Not Inserted Up To The End Of Inlet Hole | Insert The Flush Pipe Up To The End Of Inlet (For Pan Closet: Check Whether Flush Pipe Is Not Covering Flush Hole Which Is In Both Side Of Inlet Wall |
| | | Closet / Pan May Be Not Leveled | Should Be Done By Proper Leveling |
| One Piece Closet | 1. Water Not Coming In Bowl Area While Flushing | Mechanism Inside Tank Could Not Working Properly | Change The Centre Pump Of Mechanism |
| | | There Is No Water In Flush Tank | Increase The Ball Cock Height To The Max Level |
| | 2. Water Is Continuously Leaking Inside The Bowl | Mechanism Inside Tank Could Not Working Properly | Change The Centre Pump Of Mechanism |
| | 3. Water Quantity Insufficient For Effective Flushing | Ball Cock Height Adjusted At Lower Level | Increase The Ball Cock Height To The Max Level |
| Wallhung Water Closet | 1. Water Not Coming In Bowl Area While Flushing | Flush Valve May Not Working Properly / Concealed Cistern Is Not Working Properly | Should Change Flush Valve / Concealed Cistern |
| | | Flush Pipe Is Not Inserted Up To The End Of Inlet Hole | Insert The Flush Pipe Up To The End Of Inlet |
| | 2. Water Is Continuously Leaking Inside The Bowl | Closet Is Not Leveled Properly | Closet Should Be In Proper Level |
| | 3. Water Quantity Insufficient For Effective Flushing | Connection Between Closet Outlet And Drainage Pipe Is Not Proper | Should Be Done By Proper Connection By Experienced Plumber |



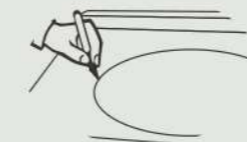
WALL HUNG BASIN

As per shown in the picture, the rag bolt must be grouted into the cement/concrete wall. The bolts must be fixed to the cement/concrete wall. Allow setting & checking than install it using nut and washer.

COUNTER WASHBASIN

At the beginning

1. A skilled or experienced person should install counter lavatories.
2. Avoid using adhesive with this product.
3. Check the waste area and supply tubing if required.
4. Do not open the lavatory from its protective carton until you are ready for installation.
5. Please follow all local building and plumbing codes.



MATERIAL & TOOLS

Measure tape, Keyhole or saber saw, Hammer, Glasses, Rags or Paper toweling, Drill (1/2 dia, drill bit or larger), Pencil, sealant, sharp knife or scissors.

INSTALLATION OF LAVATORY

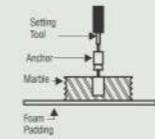
Please Note : Please install it in a way that future removal from underneath the counter top is possible without damaging the counter top.

1. Please check the desired location for clearance between the back splash, faucet, Fixture and cabinet.
2. Please cut the template.
3. Please carefully trace the template on the counter top directed.
4. Please mark the faucet hole centerline on the counter top.
5. Please drill a 1/2" pilot on the inside of the cut line.



For Wood Counter tops:

1. Mark and per-drill the wood screw holes at the locations shown on the template.
2. Waterproof any exposed areas of wood.



For Marble Counter tops:

1. Position the counter top upside down on foam padding to protect the surface. Mark and drill 3/6" holes 5/8" deep at the locations shown on the template.
2. Use a setting tool and hammer to secure the anchors.



For All Installations:

1. If the counter top has not been installed, install it at this time.
2. Drill the faucet holes according to the faucet installation instructions.
3. Install the faucet to the counter top according to the manufacture's instructions.
4. Install the drain to the lavatory according to the manufacture's instructions.

MAINTENANCE

Like any other part of your house, the bathroom can be made to look great and made to last long if it is taken care of regularly. To make your bathroom beautiful here are some invaluable tips.

Wash Basin :

A mild detergent can be used to wash the basin at least once a day. After washing, the basin should be wiped out clearly to avoid water stains.

Closets :

Cleanser like Harpic can be used to clear the closet with soft plastic brush, at least once a day.

To avoid minute discoloring, after flushing the toilet give it a once over with the soft brush.

Keep the toilet brush handy in a convenient stand nearby.

In case of toilets and basins, if there has been no maintenance since long period of time, water deposits and discoloration can form on the surface of areas that get wet. In such cases, these stains/marks can be removed with the help of a solution of dilute hydrochloric acid.

Clean with a soft cotton cloth and warm water with soap.

Do not use thinner, day cleaning liquids or powder paste. Use a liquid cleaner at least twice a week.

Use brasso or car rubbing compound and then polish with a cloth to remove fine scratches.